



# INSTRUCTION BULLETIN

No. 9009356  
Machine: See Below  
Published: 08-2013  
Rev. 01

**NOTE: DO NOT DISCARD the Parts List from the Instruction Bulletin. Place the Parts List in the appropriate place in the machine manual for future reference. Retaining the Parts List will make it easier to reorder individual parts and will save the cost of ordering an entire kit.**

*NOTE: Numbers in parenthesis ( ) are reference numbers for parts listed in Bill of Materials.*

Installation instructions for **kit number 9009500 (M20 / M30 / T20), 9009357 (S20), 9009503 (S30 / 800), 9011025 (7400)**

## SYNOPSIS:

This kit contains the parts needed to replace the main brush motor and brush drive plug on S20, S30, M20, T20, M30, 800, and 7400 machines.  
Please follow step-by-step instructions.

## SPECIAL TOOLS / CONSIDERATIONS: NONE

(Estimated time to complete: 1.5 hours)

## When assembling / disassembling hydraulic components:

1. Thoroughly clean outside of hydraulic components **before** disconnecting hydraulic hoses or fittings, flush hoses and fittings with air, solvent, or hydraulic fluid, and cap disconnected hoses and open ports to prevent contaminants from entering system.
2. Mark hydraulic hoses with locations of where they are attached. Markings make it easier to reconnect hoses to proper locations.
3. Discard all hydraulic fluid drained from the system. Use only new approved hydraulic fluid to replenish hydraulic reservoir. Hydraulic fluid is potentially dangerous to the environment. Obey all federal, state, and local laws/regulations governing the disposal of environmentally hazardous materials when disposing hydraulic fluid.



## PROTECT THE ENVIRONMENT

Please dispose of packaging materials, used machine components such as batteries and fluids in an environmentally safe way according to local waste disposal regulations.

Always remember to recycle.

## PREPARATION:

1. Raise the scrub head, park the machine on a clean level surface, turn off the machine, remove the key, and set the parking brake.

**FOR SAFETY: Before leaving or servicing machine, stop on level surface, turn off machine, remove key, and set parking brake.**

## INSTALLATION (S20 / S30 / 800 ONLY):

*NOTE: Refer to Fig. 1, Fig. 2, or Fig. 3 to install the brush drive motor (1) and Brush drive plug (2) onto the S20 / S30 / 800.*

1. If necessary, remove hardware securing the hydraulic hoses to the brush arm. Set hardware aside.
2. Disconnect the hydraulic hoses from the brush drive motor.
3. Remove all hardware securing main brush drive arm to the machine. Set hardware aside.
4. Remove the slotted hex nut securing the brush drive plug to the brush drive arm and brush drive motor. Set the cotter pin aside (if equipped). Discard the slotted hex nut.
5. Remove all hardware securing the brush drive motor to the brush drive arm. Set hardware aside. Discard the brush drive motor.

6. Install the new brush drive motor (1) onto the brush drive arm.
7. Install the key into slot on brush drive motor (1) shaft.
8. Install the brush drive plug (2) onto the brush drive motor (1) and brush drive arm.

*NOTE: Be sure the key remains in the main brush motor (1) slot when installing the brush drive plug (2).*

9. Reinstall the brush drive arm onto the machine.
10. Reconnect the hydraulic hoses to the brush drive motor.
11. If necessary, secure the hydraulic hoses to the brush drive arm.
12. Check the hydraulic fluid level. If necessary, add hydraulic fluid.

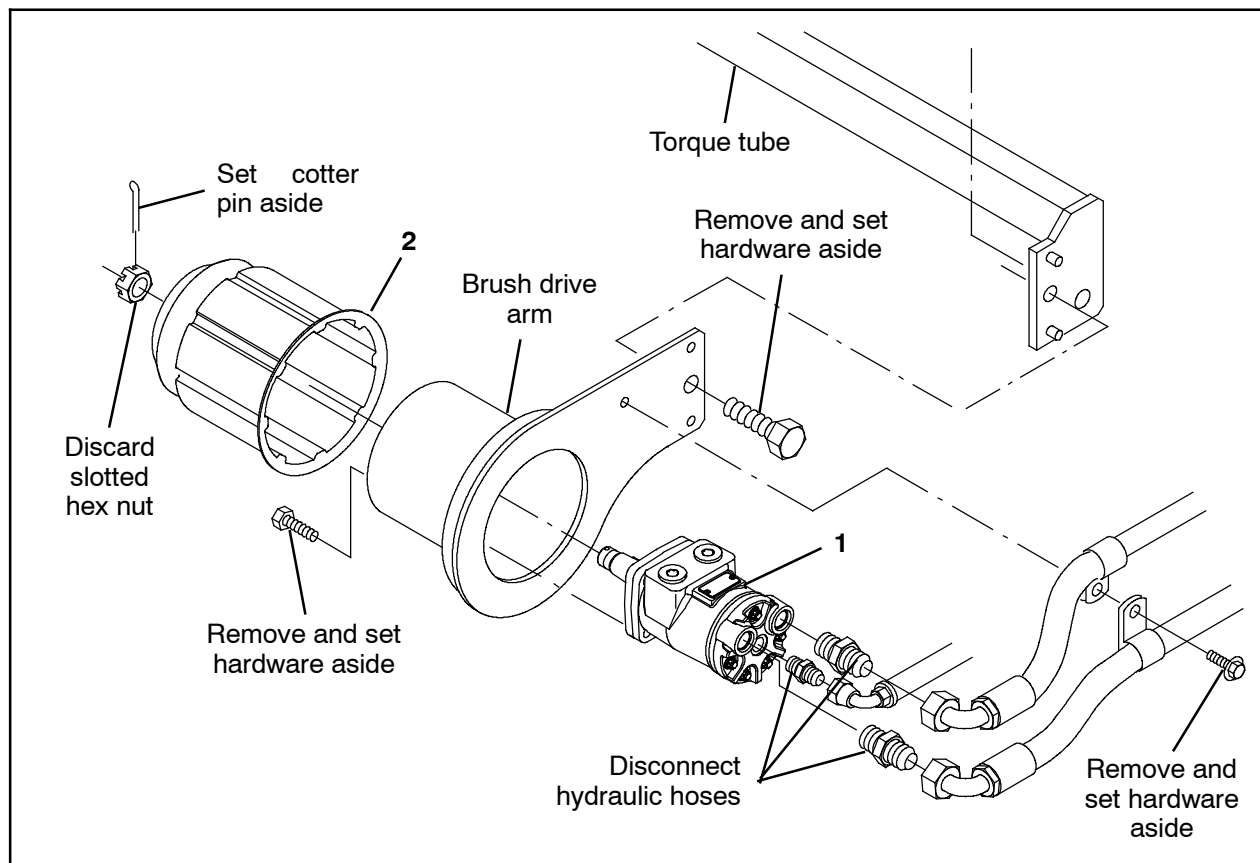
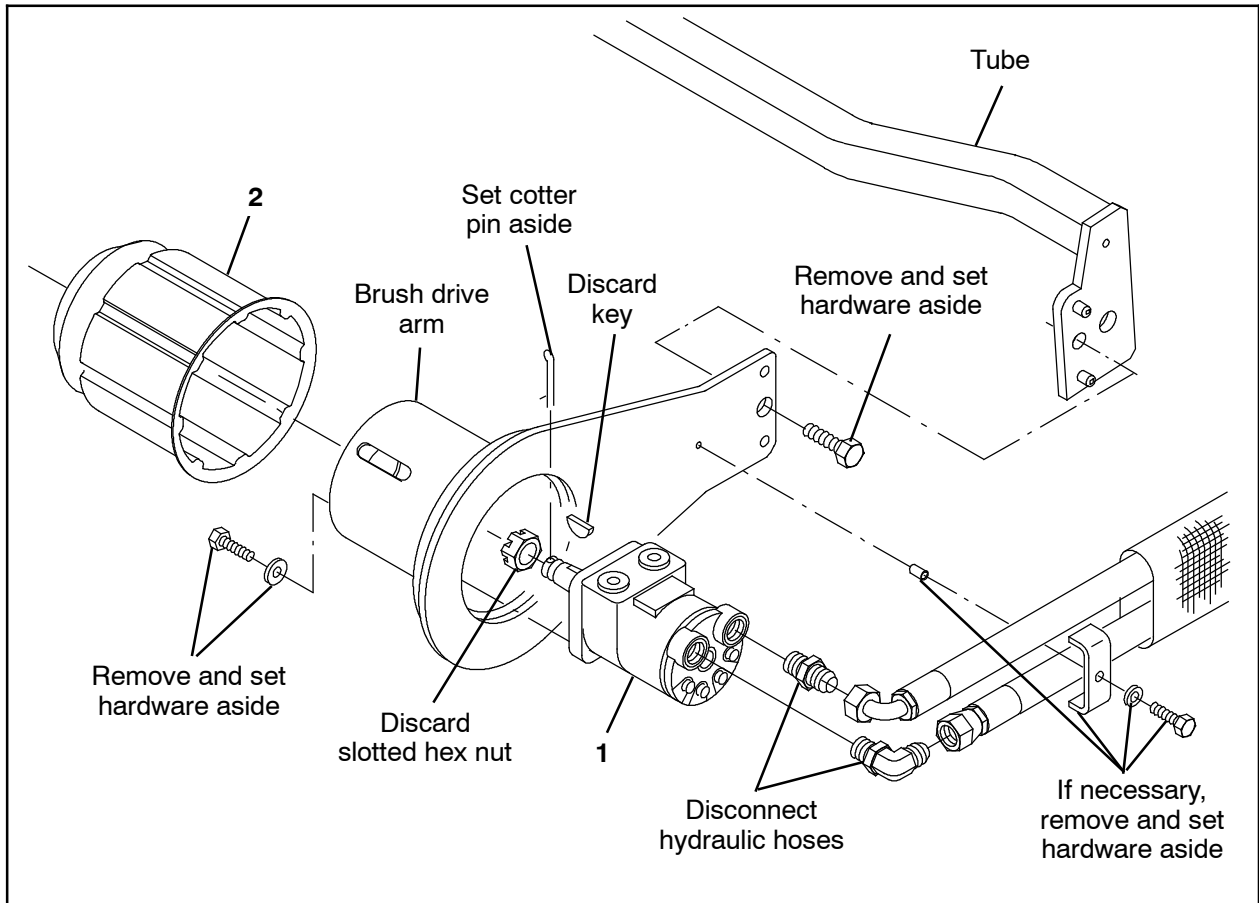

FIG. 1 - S20



**FIG. 2 - S30**

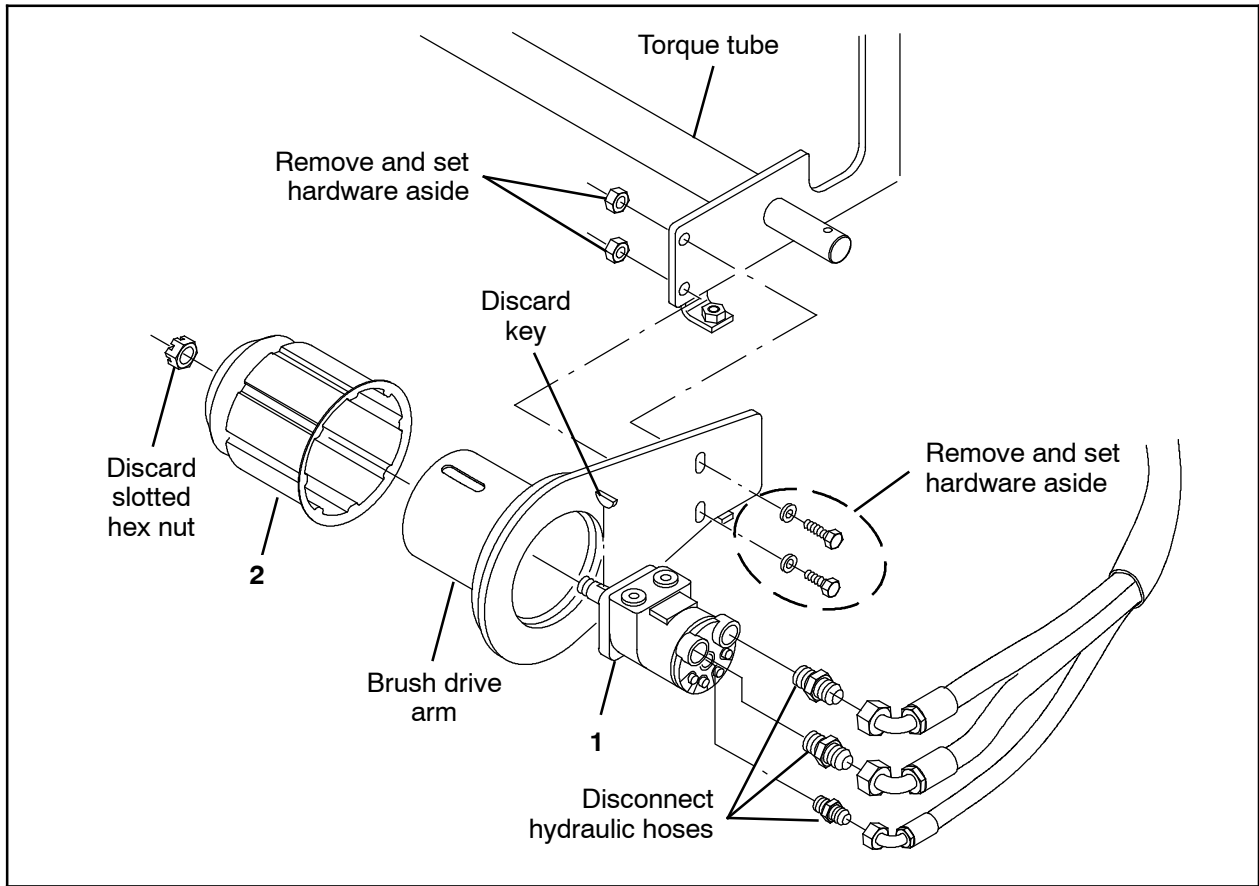

FIG. 3 - 800

## INSTALLATION (M20 / M30 / T20 ONLY):

*NOTE: Refer to Fig. 4 to install the brush drive motor (1) and brush drive plug (2) onto the M20 / M30 / T20.*

1. Disconnect the hydraulic hoses from the brush drive motor.
2. Remove all hardware securing the brush drive housing to the machine. Set hardware aside.
3. Remove the slotted hex nut securing the brush drive plug to the brush drive housing and brush drive motor. Set the cotter pin aside. Discard the slotted hex nut.
4. Remove all hardware securing the brush drive motor to the brush drive housing. Discard the brush drive motor.

5. Install the new brush drive motor (1) onto the brush drive housing.
6. Install the key into slot on brush drive motor (1) shaft.
7. Install the brush drive plug (2) onto the brush drive motor (1) and brush drive housing.

*NOTE: Be sure the key remains in the main brush motor (1) slot when installing the brush drive plug (2).*

8. Reinstall the brush drive housing onto the machine.
9. Reconnect the hydraulic hoses to the brush drive motor.
10. Check the hydraulic fluid level. If necessary, add hydraulic fluid.

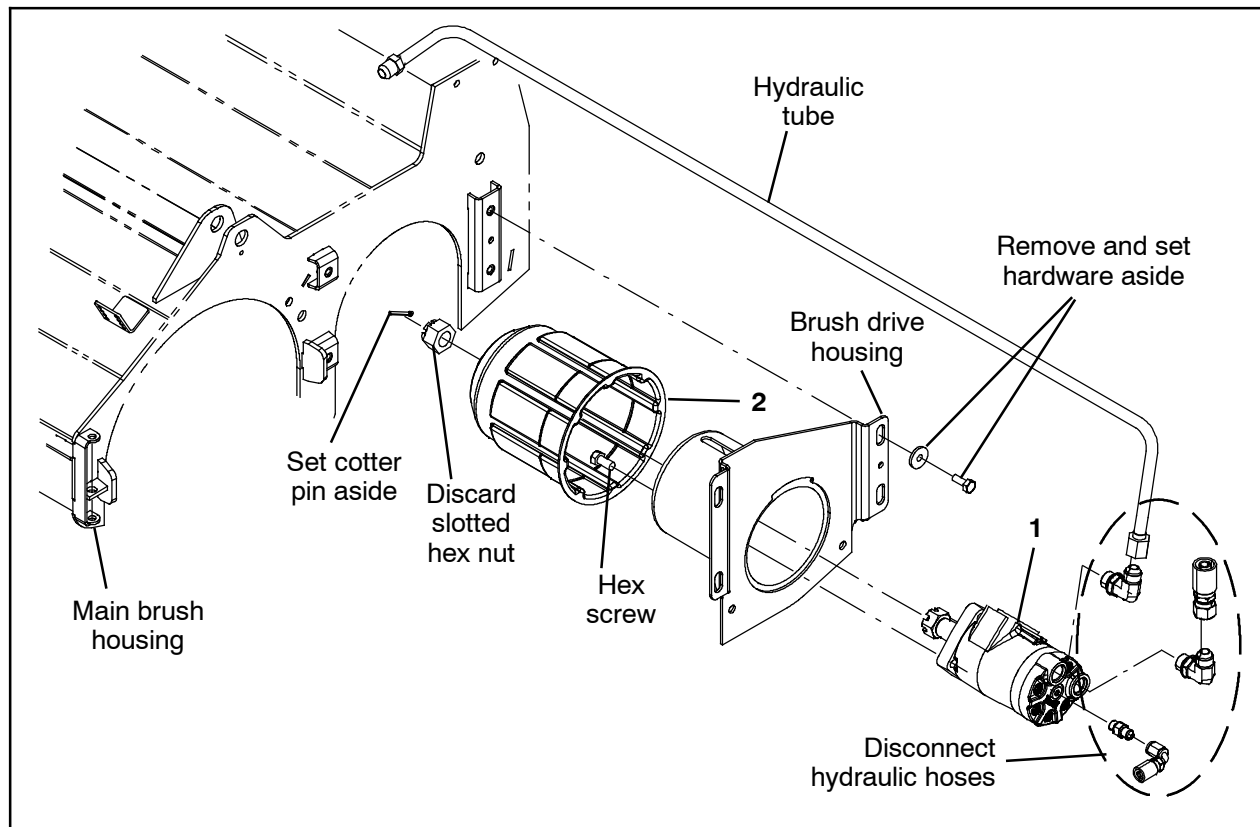

**FIG. 4 - M20 / M30 / T20**

## **INSTALLATION (7400):**

*NOTE: Refer to Fig. 5 to install the brush drive motor (1) and brush drive plug (2) onto the 7400.*

1. Open the brush door.
2. Disconnect the leveling rod from the machine frame.
3. Remove the brush arm from the machine. Set the brush arm and all hardware aside.
4. Disconnect the hydraulic hoses from the brush drive motor.
5. Remove all hardware securing the brush mounting plate to the machine. Set the hardware aside.
6. Remove the slotted hex nut securing the brush drive plug to the brush mounting plate and brush drive motor. Set the cotter pin aside. Discard the slotted hex nut.
7. Remove all hardware securing the brush drive motor to the brush mounting plate. Discard the brush drive motor.
8. Install the new brush drive motor (1) onto the brush mounting plate.
9. Install the key into slot on brush drive motor (1) shaft.
10. Install the brush drive plug (2) onto the brush drive motor (1) and brush mounting plate.

*NOTE: Be sure the key remains in the main brush motor (1) slot when installing the brush drive plug (2).*

11. Reinstall the brush mounting plate onto the machine.
12. Reconnect the hydraulic hoses to the brush drive motor.
13. Reinstall the brush arm onto the machine.
14. Reconnect the leveling rod to the machine frame.
15. Check the hydraulic fluid level. If necessary, add hydraulic fluid.

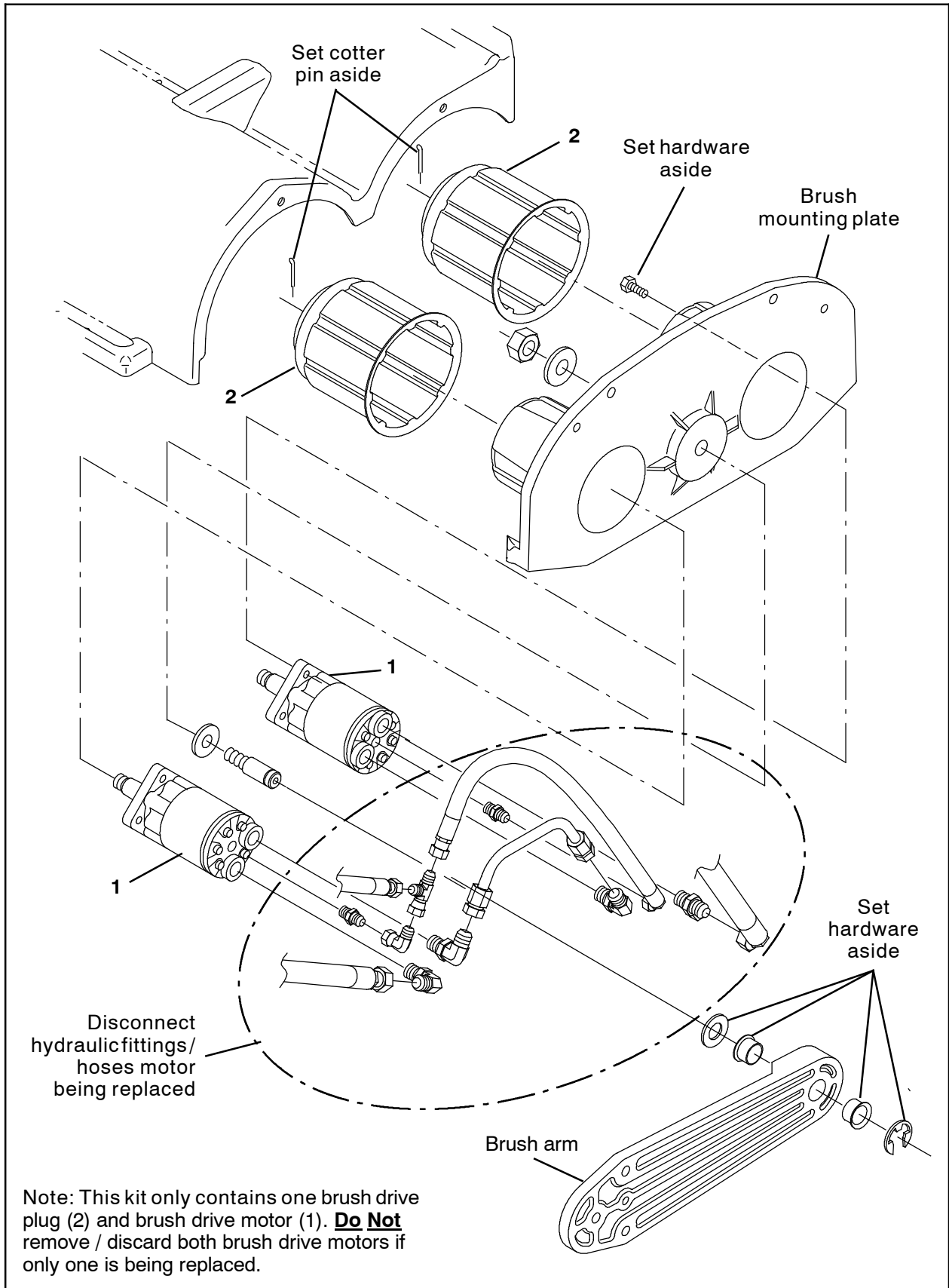

FIG. 5 - 7400

---

**Bill Of Materials For Motor Kit, Main Brush, Replmt [S20] - 9009357**

	<b>Ref.</b>	<b>Tennant Part No.</b>	<b>Description</b>	<b>Qty.</b>
▽		9009357	Motor Kit, Main Brush, Replmt [S20]	1
▲	1	1068806	Motor, Hyd, Gear, Int 02.2 Bi- Dir 1500	1
▲	2	1057643	Plug, Wldt, Drive, Brush	1

**Bill Of Materials For Motor Kit, Main Brush, Replmt [MAKO] - 9009500**

	<b>Ref.</b>	<b>Tennant Part No.</b>	<b>Description</b>	<b>Qty.</b>
▽		9009500	Motor Kit, Main Brush, Replmt [MAKO]	1
▲	1	1068811	Motor, Hyd, Gear, Int 04.5 Bi- Dir 1500	1
▲	2	1057643	Plug, Wldt, Drive, Brush	1

**Bill Of Materials For Motor Kit, Main Brush, Replmt [S30 / 800] - 9009503**

	<b>Ref.</b>	<b>Tennant Part No.</b>	<b>Description</b>	<b>Qty.</b>
▽		9009503	Motor Kit, Main Brush, Replmt [S30 / 800]	1
▲	1	1057337	Motor, Hyd, Gear, Int 02.8 Bi- Dir 1500	1
▲	2	1057643	Plug, Wldt, Drive, Brush	1

**Bill Of Materials For Motor Kit, Main Brush, Replmt [7400] - 9011025**

	<b>Ref.</b>	<b>Tennant Part No.</b>	<b>Description</b>	<b>Qty.</b>
▽		9011025	Motor Kit, Main Brush, Replmt [7400]	1
▲	1	1068811	Motor, Hyd, Gear, Int 04.5 Bi- Dir 1500	1
▲	2	1072405	Plug, Wldt, Drive, Brush [7400 H Series]	1

TENNANT COMPANY  
P. O. Box 1452  
Minneapolis, MN 55440-1452